

SOMMER pro⁺



Ceiling suspension unit

- Easy to install and versatile

Rail

- The rail unit (standard equipment) opens sectional doors up to a height of 2,500 mm, one piece doors up to a height of 2,750 mm
- By extending the rail, even taller doors can be opened

Rail extension 543 mm #S10868-00001
Rail extension 1,096 mm #10460V000

Chain

- High-quality fixed chain (galvanic nickel-plated)
- Wear- and maintenance-free, pre-tensioned via springs with high tensile strength

Motor carriage

- Certified restriction of closing forces acc. to EN 12445 by electronic motor monitoring (Ifi Rosenheim-certified)



With intelligent control technology for dealers, there are additional options for easily adjusting features and parameters with a web app using your smartphone or tablet. (SOMlink #7040V000; Page 148)

Quality

- pro⁺ is the innovative successor to the successful base⁺ garage door operator from SOMMER: Now even more flexible and convenient due to the separate control unit housing
- Universal operator for sectional doors, overhead doors, one piece doors, up-and-over doors ¹⁾, hinged double doors ¹⁾ and side-opening sectional doors
- Integrated LED technology: durable, energy-saving and efficient lighting
- Saves power: < 1 watt standby
- Made in Germany

Safety

- Motor with high self-locking and active counter-pressure in all positions in the event of an attempted break-in
- Connection option for battery pack for emergency operation in the event of a power failure
- Locking magnet for motor (secure against break-ins), locks in any position, even during ventilation function, partial opening and door OPEN final position (Lock # 1651V000 available as an option)
- Thanks to the integrated emergency release, the motor carriage can be engaged and disengaged in any position
- Bidirectional, secure SOMloq2 radio control system

Versatility

- Numerous accessories for extension, e.g. Memo handheld transmitter memory, Senso humidity sensor, Lock locking magnet, Lumi pro⁺ additional LED lighting
- 2 integrated control buttons in the control unit housing for activating the door and the lighting/partial opening function or "Defined opening" and "Defined closing"
- Additional connection options directly on the motor carriage (wicket door contact and safety contact strip OSE or 8k2)
- Universal power supply to the rail (can either be from the front or the rear)
- Motor carriage can be removed without disassembling the rail
- Short cable runs with wall mounting for external accessories (photocell/warning light/ external buttons...)

Intelligence

- Automatic learning process: self-learning force curve with continual adjustment, e.g. summer/winter mode
- Optimised speed profiles for quick opening and secure closing
- Operation compliant with standards
- Automatic calibration of door operation through direct entry of measured operating forces
- Pre-selectable door types via DIP switch
- Active braking for moving doors
- Numerous setting and querying options via SOMlink
- Gear-saving soft start/stop
- Automatic end position detection in door CLOSE when programming, the closing pressure can also be individually adapted to the structural conditions



You can find further information at www.sommer-pro.eu.

¹⁾ Special fitting required

Flexibility

- Separate control unit housing for installing on the wall or ceiling, depending on your requirements. The existing power socket in the garage is optimally suited for the power supply.
- When installing the separate control unit housing on the wall, the interior push-buttons are a convenient distance from the exit door
- The control unit housing, which can be installed separately, makes an additional power socket and complex electrical work unnecessary

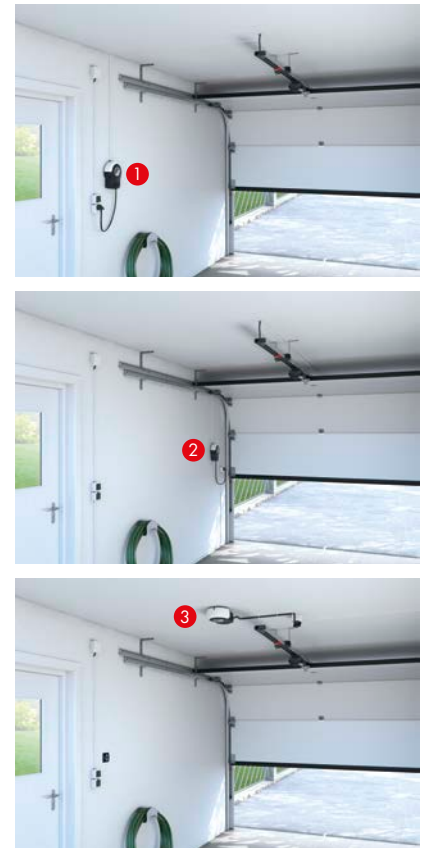

The control unit can be mounted at the rear **1**, at the front **2** or on the ceiling **3**.

SOMMER pro⁺

- Motor carriage with integrated radio receiver (FM 868.95 MHz SOMloq2, 40 radio memory positions)
- Control unit housing with two integrated interior push-buttons
- LED lighting in the motor carriage
- Pre-programmed Pearl Vibe 4-command handheld transmitter (#4019V000) with noticeable feedback of radio commands via vibration
- 3-piece rail, motor carriage, control unit housing, ceiling suspension unit, attachment to header, push arm, door bracket and mounting material



S 9060 pro⁺ NEW S10154-00001

- 600 N pull and pushing force

S 9080 pro⁺ NEW S10155-00001

- 800 N pull and pushing force

S 9110 pro⁺ NEW S10156-00001

- 1100 N pull and pushing force



* You can find the detailed warranty terms at www.sommer.eu.